

**UNDER NEW OWNERSHIP - COMPLETE BUILDING RENOVATION IN PROGRESS**



**FOR LEASE**

**SMALL BAY INDUSTRIAL SPACES IN THE HEART OF CAMPBELL**

**299 E MCGLINCY LANE - CAMPBELL, CA 95008**

**COLE STROMBOM**

650-302-3805

cole@strombom.com

LIC. #01953946

**OFFICE CONTACT**

916-299.6698

www.strombom.com

LIC. #02155363



## PROPERTY DESCRIPTION

---



- Hard to find small bay industrial spaces located in the heart of Campbell
- Building is being completely renovated including a new roof, parking lot, paint and more
- Ideal unit sizes ranging from 1,510 SF to 4,910 SF
- Potential for up to 9,420 SF for larger users
  - **SEE CONCEPTUAL DEMISING PLAN ON FOLLOWING PAGE**
- Each unit has at least one garage roll up door and a restroom
- Zoning: M-1 (Light Industrial)
  - Click here for a link to Campbell's zoning code: **M-1 ZONING**



# UNIT 281 - CONCEPTUAL DEMISING PLAN

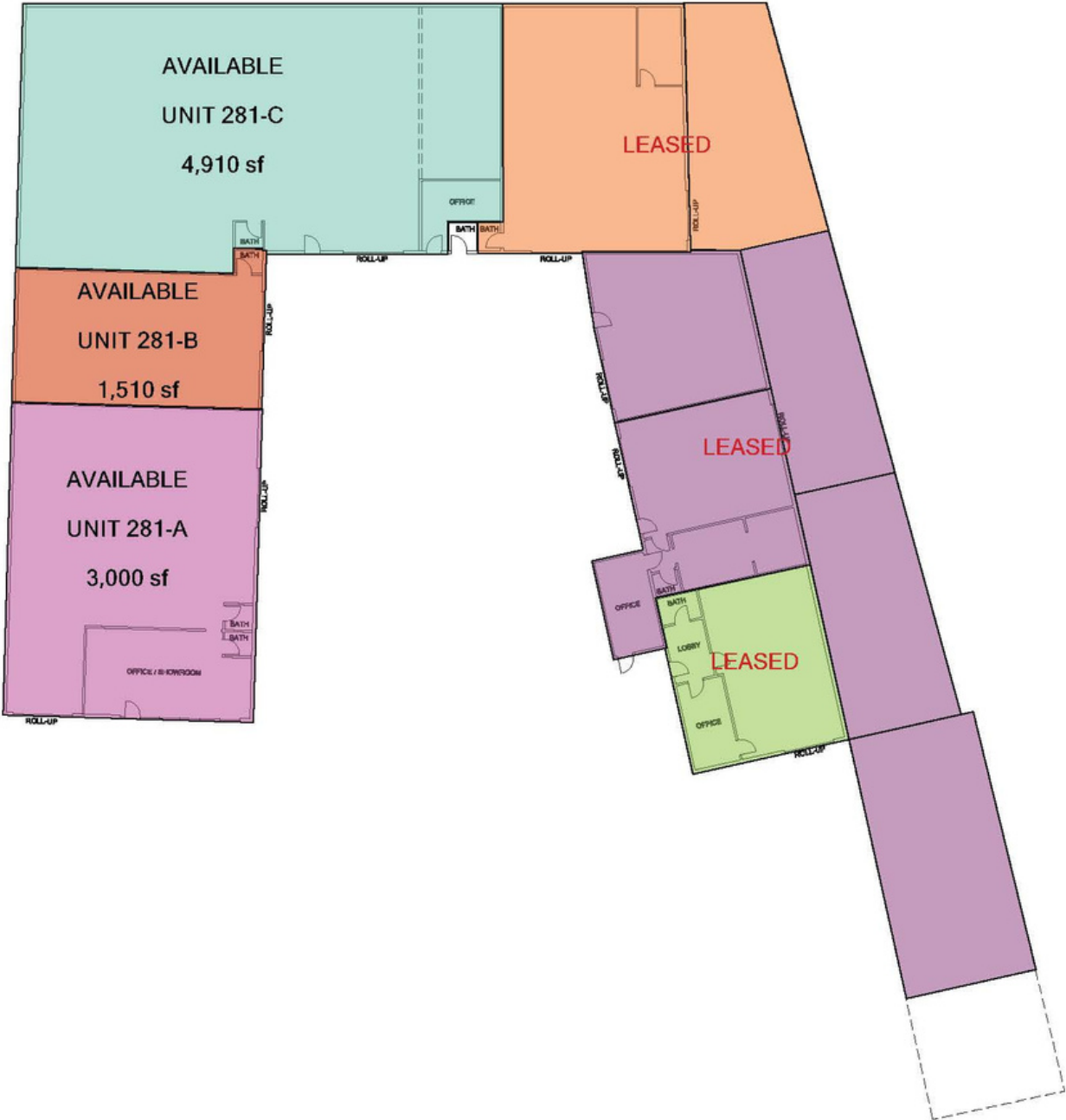

# LOCATION - NEIGHBORHOOD AERIAL

